



THE GALLERY AT LOWE MILL

Located at The Gallery, an upcoming multifamily development in the heart of Huntsville's Lowe Mill art district, this restaurant space is positioned in a growing area with easy access to high-traffic Memorial Parkway. It is centrally located and within a short drive of Downtown Huntsville, Cummings Research Park, and Redstone Arsenal.

CRUNKLETON COMMERCIAL REAL ESTATE:

Anusha Alapati Davis - 256.384.7608

EQUITABLE PROPERTY COMPANY:

Elliott Kyle - 615.491.7416



LOCATION

Seminole Drive & 9th Avenue
Huntsville, AL 35805

SPACE AVAILABLE

2,940 SF Of Restaurant Space

PROPERTY HIGHLIGHTS

- Includes large outdoor patio space.
- Excellent views of the neighborhood.
- Features 20' high ceiling throughout.
- Lots of on-site parking for patrons.
- The Gallery will have 107 multifamily units, lending more traffic to the future restaurant user.
- Impressive drive-time market with more than 200,000 people within 15-min.
- Located next to Lowe Mill ARTS & Entertainment, the nation's largest privately owned facility with hundreds of private studios, galleries, a theatre, community garden, and performance venues.
- Close to numerous high-traffic developments including Stovehouse; Campus 805; The Foundry; The Range, and planned multifamily projects like Mural @ Stovehouse; and Avenue Six.

DEMOGRAPHICS

	1 Mile	3 Mile	5 Mile
Population	5,690	65,062	123,728
Households	2,750	28,839	52,066
Avg Household Income	\$53,164	\$70,848	\$73,877
Avg Vehicles Per Day	82,289 ± On Memorial Pkwy		

ABOUT THE AREA

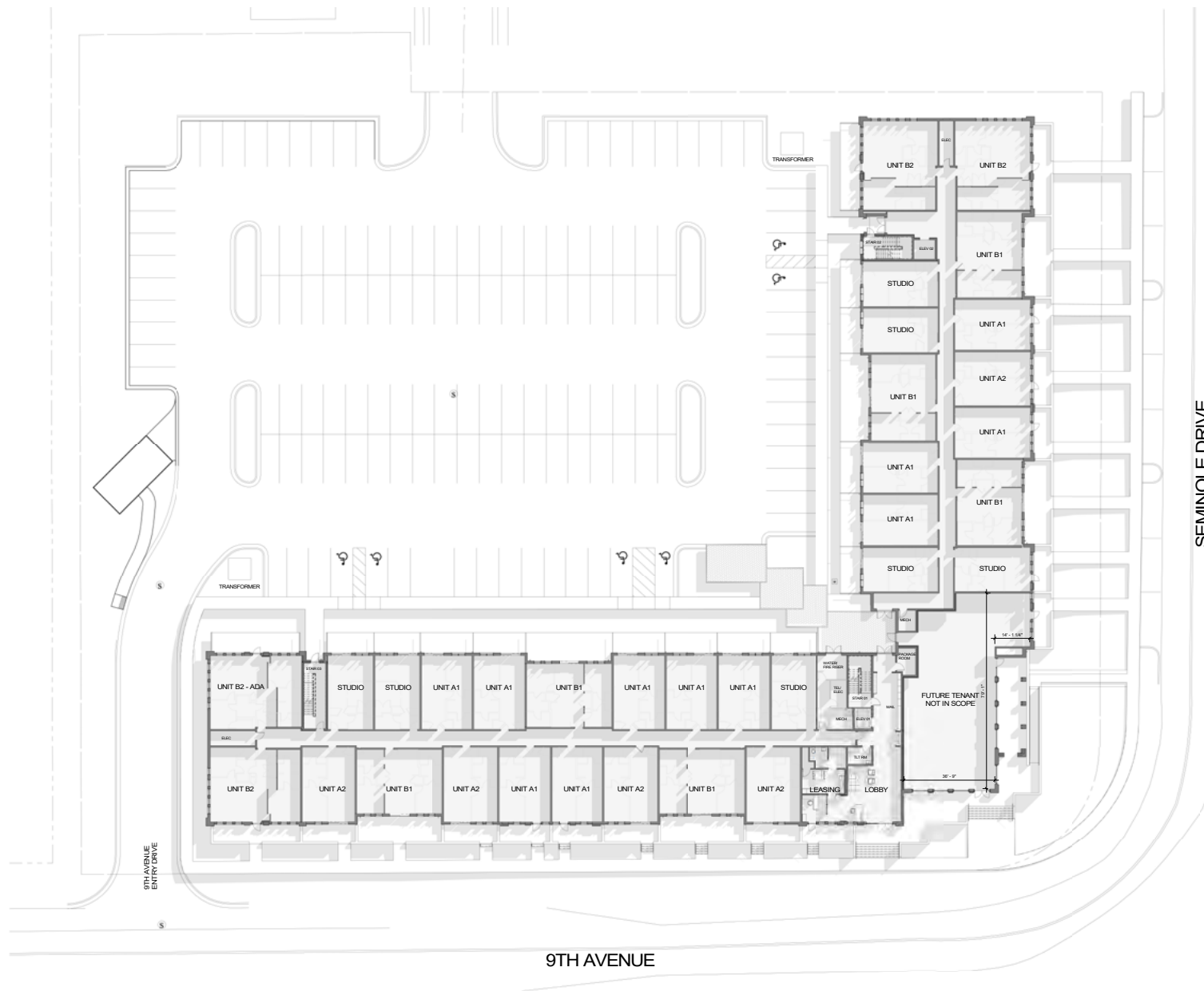

SITE PLAN