

# 415-E CHURCH STREET - HUNTSVILLE, AL

## OFFICE SPACE FOR LEASE



### PROPERTY HIGHLIGHTS

- Suite 3 includes lobby/reception area, four medium-sized offices and four large-sized offices, and kitchen.
- Downtown location in close proximity to many entertainment, retail, and restaurant options.
- Abundant parking available for employees and clientele.
- Church Street is now widened and it includes a new intersection at Pratt Avenue.
- Easily accessible to I-565, Memorial Pkwy, and Hwy 72.
- Two coffee shops within walking distance: Mason Dixon and Canadian Bakin'.

### ABOUT THE PROPERTY

Located in the heart of Downtown Huntsville, this five-building complex has office suites available. Other tenants in the complex include Mason Dixon Bakery & Bistro, Sidetracks Music Hall, and several others.

### AVAILABLE SUITES

**Suite 3**                      2,100 SF

### LOCATION

415-E Church Street  
Huntsville, AL 35801

### PRICE

Please call for pricing.

### FOR MORE INFORMATION CALL

Eric St. John, CCIM  
256-384-7603  
eric@crunkletonassociates.com



**CRUNKLETON**  
COMMERCIAL REAL ESTATE GROUP

# MAP SHOWING PROPERTY LOCATION



# SUITE 3 - 2,100 SF

BACK DOOR

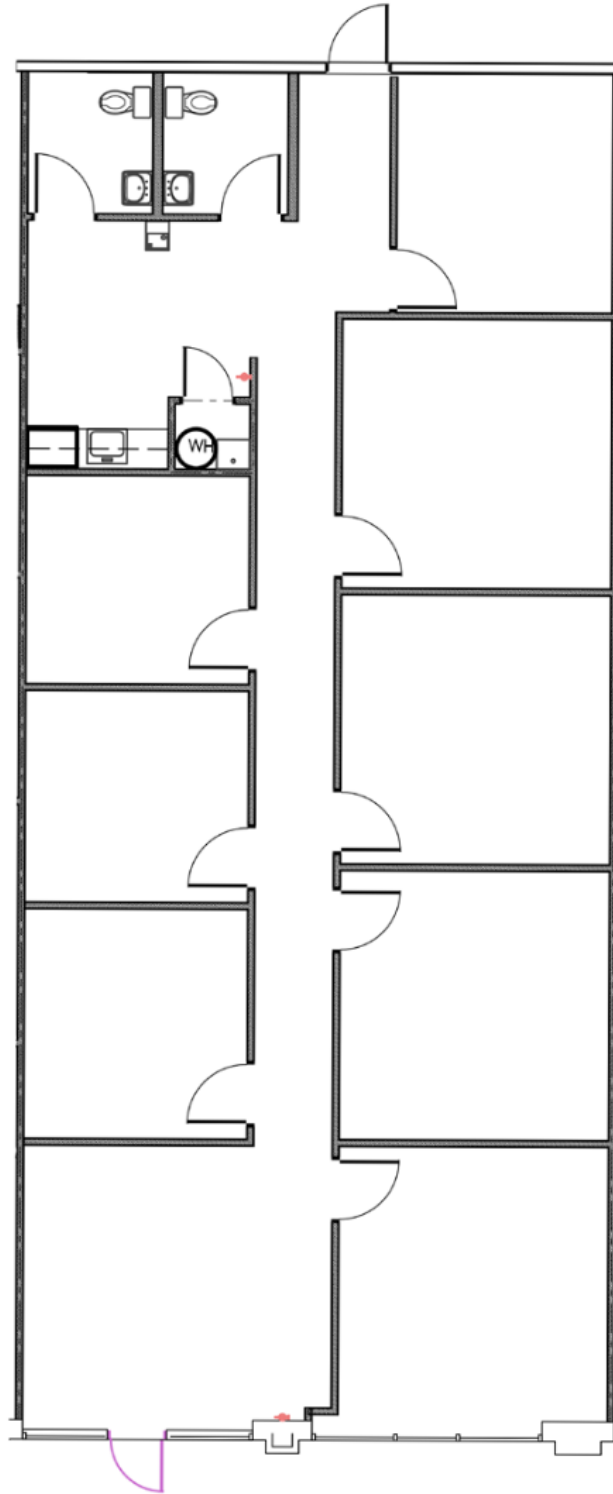

FRONT DOOR